

Magic Tees

W/G Size	Figure	Frequency GHz	Electrical Data					Mechanical Data		
			Model Number ⁺	VSWR Maximum		Isolation DB Min Between E & H Arms	Unbalance DB	in inches (without flanges)		
				H Arm	E Arm			L	E	H
WR28	1A	29.0-34.0	28TN16	1.25	1.25	35	±.20	0.75	0.50	0.50
WR42	1A	20.0-24.0	42TN16	1.25	1.30	40	±.20	1.12	0.83	0.75
WR51	1A	15.8-17.5	51TN16	1.15	1.15	40	±.10	1.52	1.12	1.09
WR62	1A	15.4-17.2	62TN26	1.30	1.20	40	±.15	1.52	1.12	1.09
WR75	1A	10.35-12.35	75TN16	1.25	1.25	40	±.10	2.50	1.49	1.67
WR90	1A	8.5-9.6	90TN16	1.25	1.30	40	±.10	2.30	1.47	1.14
	1A	9.0-10.2	90TN26	1.15	1.15	40	±.10	2.30	1.47	1.14
	3	8.9-9.4	A90TN12 ^B	1.15	1.20	35	±.15	2.00	.70	1.00
	2	8.8-10.06	A90TN22 ^A FOLD E	1.25	1.25	30	±.25	1.96	.29	.68
WR112	4	8.5-9.6	C90TN12 ^C	1.20	1.25	35	±.10	2.00	.56	.75
	1B	8.5-9.6	112TN16 ^E	1.10	1.15	40	±.10	3.20	1.60	1.60
WR137	1B	7.0-7.6	112TN26 ^E	1.20	1.25	40	±.10	3.20	1.60	1.60
	1A	5.4-5.9	137TN16	1.15	1.10	40	±.10	3.62	1.90	1.90
WR159	1A	5.9-6.5	137TN26	1.30	1.25	40	±.10	3.62	1.90	1.90
	1A	5.1-5.95	159TN16	1.15	1.15	40	±.10	4.25	2.12	2.12
WR187	1A	5.4-5.9	187TN16	1.15	1.15	40	±.10	3.68	2.68	2.52
WR284	1A	2.9-3.5	284TN16 ^D	1.25	1.25	40	±.10	4.40	3.53	3.53
	1A	3.1-3.5	284TN26 ^D	1.15	1.20	40	±.10	4.40	3.53	3.53

Notes: ⁺ Model Numbers represent unit dimensions without flanges.
See page 46 for ordering information on flange combinations.

- ^A .200 Height.
- ^B .200 Height. E arm corral cast for .030 W/G wall.
- ^C .150 Height. Outputs corraled, E and H arms male W/G.
- ^D Supplied in Alum only.
- ^E Supplied with flanges only, per figure 1B.

1 = Supplied in figure 1A or 1B configuration.

MAGIC TEES

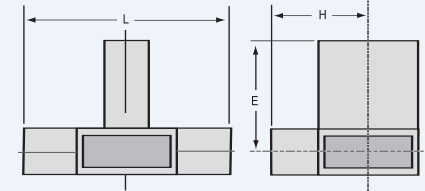

FIG. 1A (No Flanges)

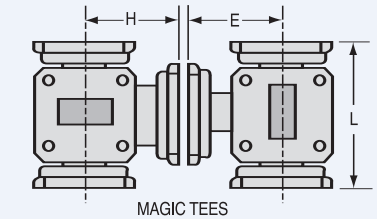

FIG. 1B (With Flanges)

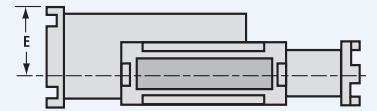

FIG. 2

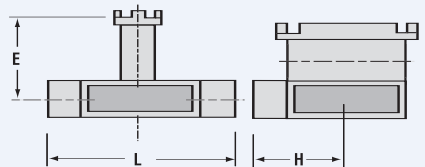

FIG. 3

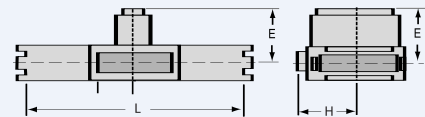

FIG. 4